

THIS COPY IS PROVIDED ON A RESTRICTED BASIS AND IS NOT TO BE USED IN ANY WAY DETRIMENTAL TO THE INTERESTS OF PANDUIT CORP.

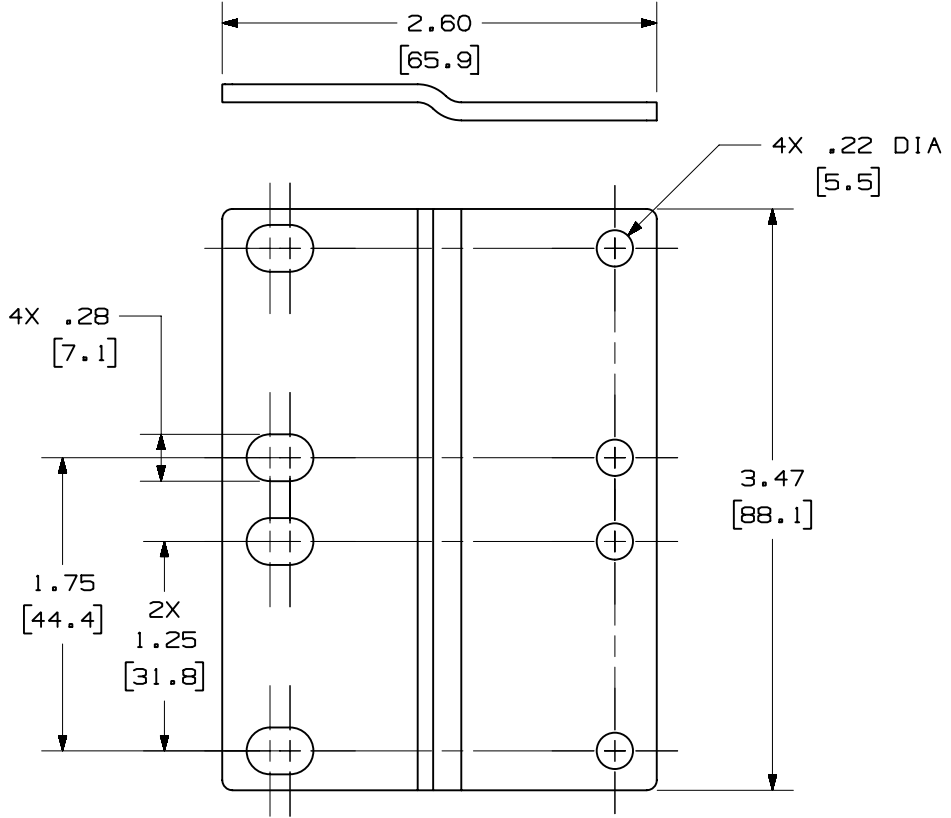

PANDUIT P/N	WEIGHT
PEB2	5.38 LB/10 PCS (2440.3 g/10 PCS)

- NOTES:
- SEE CATALOG FOR COMPLETE LIST OF PARTS APPLICABLE FOR USE WITH THIS PART.
 - DIMENSIONS IN PARENTHESES ARE IN METRIC.
 - PART INCLUDES:
2- EXTENDER BRACKET
4- 12-24 SCREWS
4- M6 METRIC SCREWS

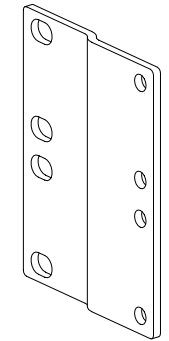

CAD FILENAME/LAYERS M00673CB_DC_00B.PRT

PANDUIT CORP. TINLEY PARK, ILLINOIS

2 RACK UNIT PANEL EXTENDER BRACKET (PEB2) CUSTOMER DRAWING

UNLESS OTHERWISE SPECIFIED, DIMENSIONAL TOLERANCES ARE:
(.X) ± (.XXX) ± .010 (.3)
(.XX) ± .03 (.8) ANGLES ±

UNLESS OTHERWISE SPECIFIED, ALL DIMENSIONS ARE GIVEN IN INCHES, THIRD ANGLE PROJECTION.

REV	DATE	BY	CHK	DESCRIPTION	ECN	CHK	CUST	SUP
I	5-2-02	JDWE		A. ADDED METRIC SCREWS.	00673-11			
R	1-5-00	JsP	KLGO	RELEASED TO PRODUCTION.	00673-11	RLFR	RLFR	

DRAWN BY JsP
DATE 1-5-00
CHECKED BY KLGO

MAT'L:

SCALE NONE
DRAWING NO. 00673-11
DWG SIZE A